

# Reducer navoja RD

**PREGLED**



**RD**

**Svojstva:**

Materijal	GSMnPb28k (materijal br. 1.0718) prema DIN EN 10087
Pocinkovanje	Galvanski pocinkovano, 3 - 8 µm

**TEHNIČKI PODACI**

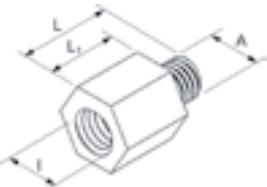

Tip	Bc. art.	Pakovanje [Komada]	Unutrašnji navoj I	Spoljni navoj A	Dužina L1 [mm]	Dužina L [mm]	Širina ključa SW						
RD M 6 / M 8	<b>079694</b>	100	M 6	M 8	12	20	9						
RD M 8 / M 6	<b>020936</b>	100	M 8	M 6	12	19	11						
RD M 10 / M 8	<b>079692</b>	50	M 10	M 8	15	23	13						
RD M 12 / M 10	<b>079693</b>	100	M 12	M 10	15	25	17						
RD M 12 / M 16	<b>504397</b>	50	M 12	M 16	18	32	19						
RD M 16 / M 12	<b>504399</b>	50	M 16	M 12	22	32	24						
RD 1/2" / M 10	<b>079695</b>	10	1/2"	M 10	19	29	24						

Montažni pribor

# Navrtka redukovana RDM i GRD

**PREGLED**



**RDM**



**GRD**

**Svojstva:**

Materijal	11SMnPb30 (materijal br. 1.0718) prema DIN EN 10277
Pocinkovanje	Galvanski pocinkovano, 3 - 8 µm

**TEHNIČKI PODACI**

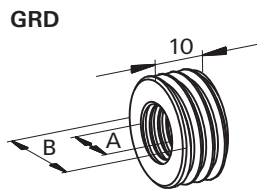
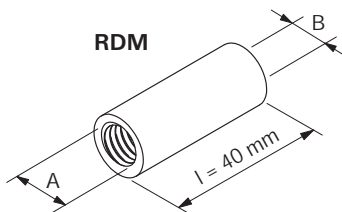

Tip	Bc. art.	Pakovanje [Komada]	Navoj A	Navoj B									
RDM M 10 / M 8	<b>079413</b>	50	M 10	M 8									
RDM M 12 / M 10	<b>079414</b>	100	M 12	M 10									
GRD 1/2" / M 10	<b>077609</b>	100	M 10	1/2"									
GRD 1/2" / M 12	<b>077608</b>	100	M 12	1/2"									
GRD 3/4" / M 10	<b>077607</b>	100	M 10	3/4"									
GRD 3/4" / M 12	<b>077606</b>	100	M 12	3/4"									